

# Contours® MaxLite™

## DELUXE LIGHTWEIGHT STROLLER



Scan for instructional video



Escanee para obtener  
instrucciones en español

Model # ZU001  
S150-R1 10/2022

# IMPORTANT - READ CAREFULLY AND KEEP FOR FUTURE REFERENCE

## WARNING

Your child's safety depends on you. Proper product use cannot be assured unless you follow these instructions.

### How to Keep Your Child Safe While Using this Stroller

- **Adult assembly required.**
- **Never leave the child unattended.** Accidents can happen quickly while your back is turned. You must always keep your child in view while your child is in the stroller, even when sleeping.
- **Ensure that all locking devices are engaged before use.** This prevents injuries caused by stroller collapsing before allowing your child in or near the product.
- Parking brake shall be engaged when placing and removing the children from the product.
- Always set the wheel brakes when stroller is not moving, especially on an incline. This prevents the product from rolling away.
- **To avoid injury ensure that the child is kept away when unfolding and folding this product.**
- Moving parts on product may create injuries such as finger pinching.
- **Do not let the child play with this product.**
- To prevent the product from becoming unstable, do not place parcels or accessory items on the canopy, seat, sides of chassis / frame, or over the handle.
- **DO NOT put child in storage basket.**
- **This seat unit is not suitable for children under 6 months.**
- This stroller shall be used with one child only.
- Only use this product with children who weigh no more than 50 lb / 22.7 kg.
- **Avoid serious injury from falling or sliding out. Always use the restraint system.**
- Never use this product on stairways or escalators.
- **This product is not suitable for running or skating.**
- Only use accessories and/or replacement parts supplied or recommended by the manufacturer.
- To prevent this product from becoming unstable or tipping, do not put more than 5 lb / 2.27 kg in storage basket.
- To prevent this product from becoming unstable or tipping, do not put more than 3 lb / 1.36 kg in the cupholder.
- Do not put hot liquids in cupholder - hot liquids can burn your child.

## PARTS LIST

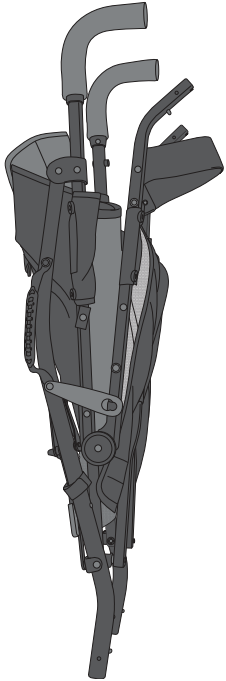

STROLLER FRAME

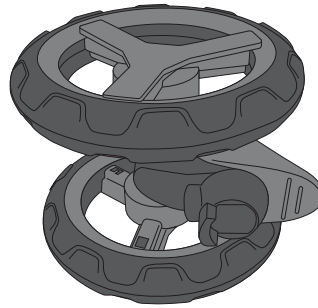

FRONT WHEELS (2)

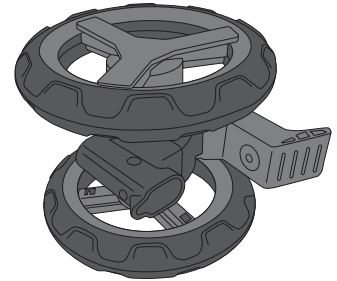

REAR WHEELS (2)

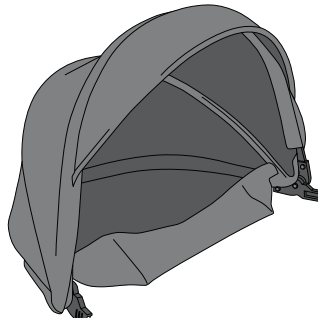

CANOPY

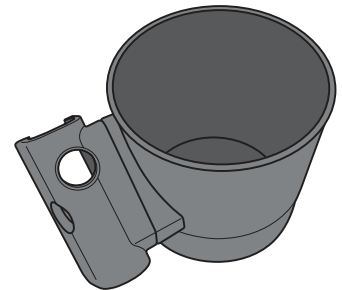

CUP HOLDER

## OPEN STROLLER

1-1

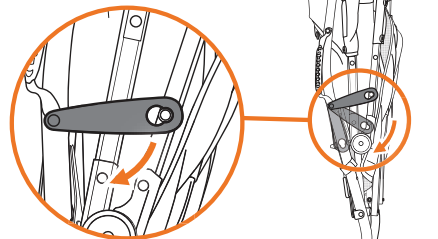

1-2

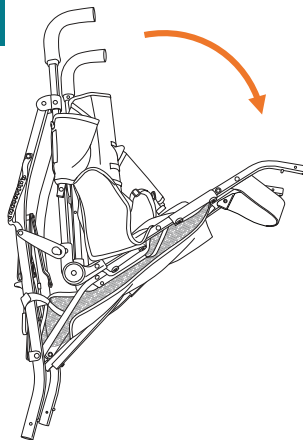

1-3

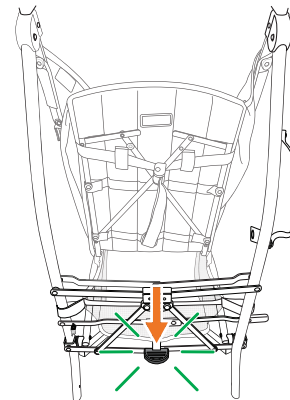
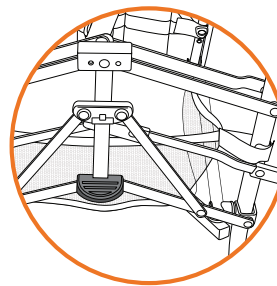

## ATTACH FRONT WHEELS

2-1

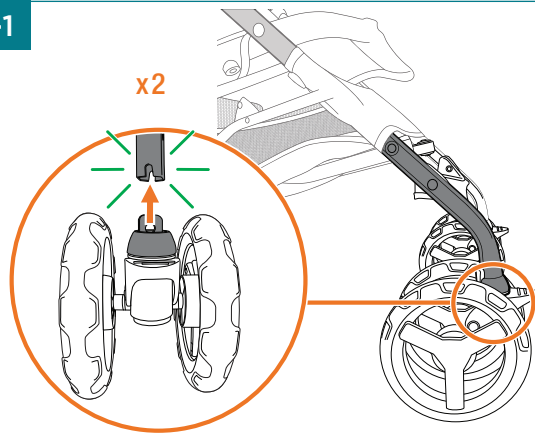

TO REMOVE

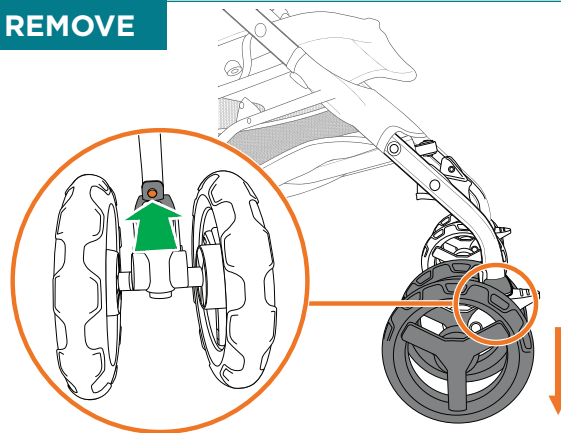

## ATTACH REAR WHEELS

3-1

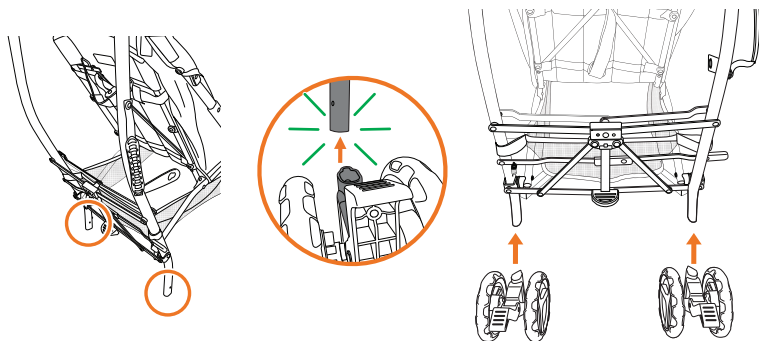

TO REMOVE

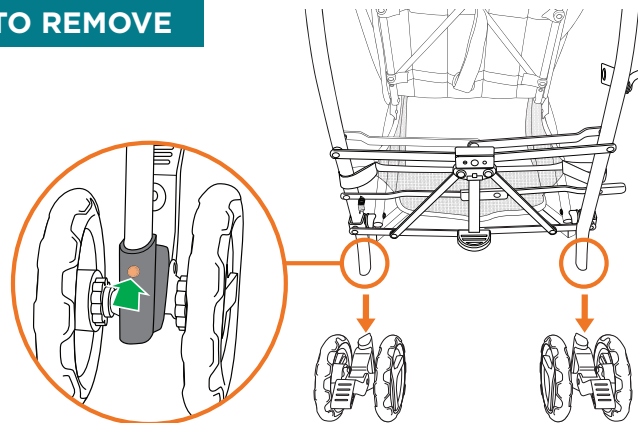

## ATTACH CANOPY

4-1

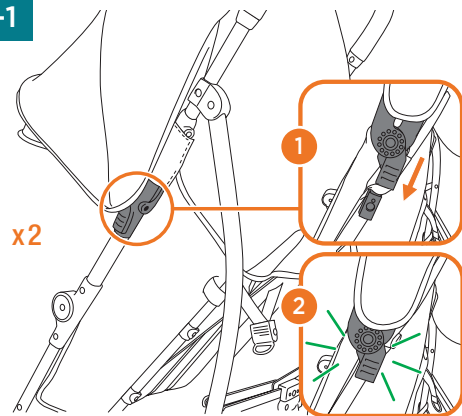

4-2

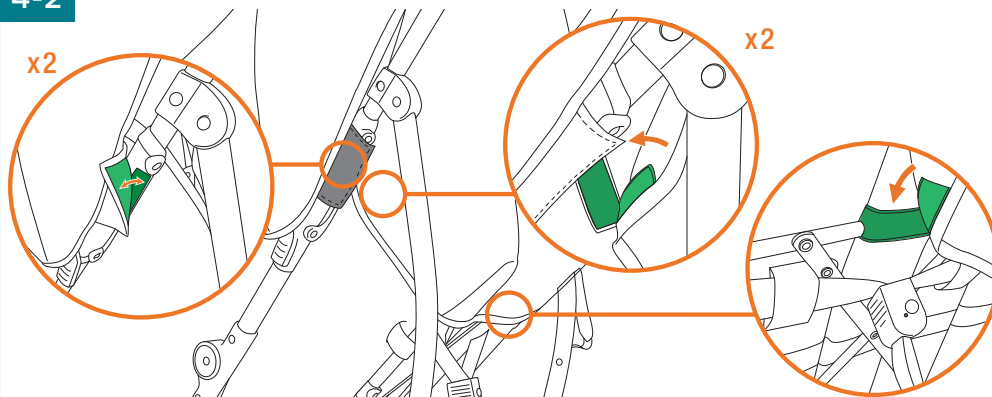

## ATTACH CUP HOLDER

5-1

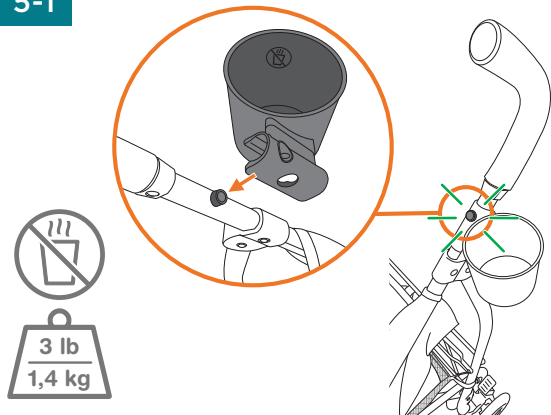

## ADJUST SEAT

6-1

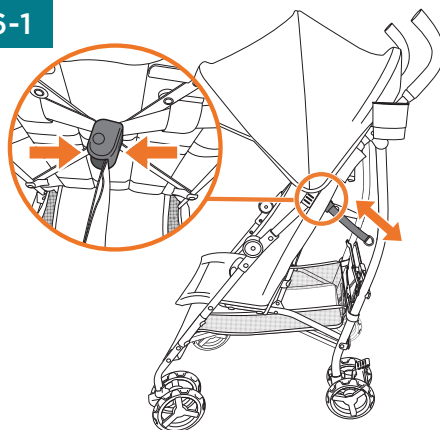

## ADJUST CANOPY

7-1

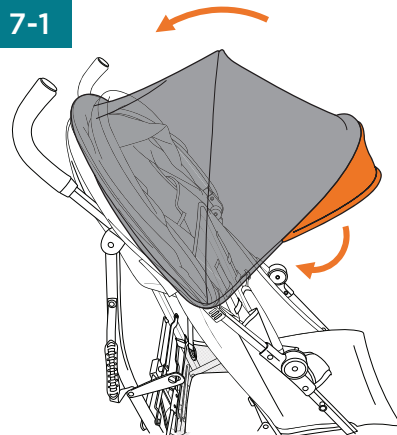

## LOCK FRONT WHEEL SWIVEL

8-1

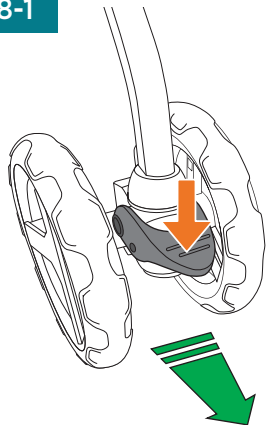

8-2

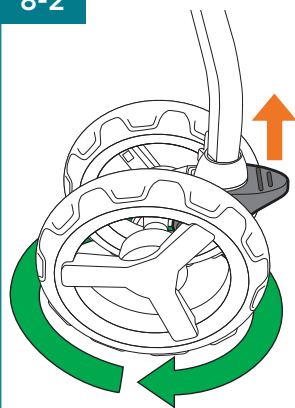

## OPERATE BRAKES

9-1

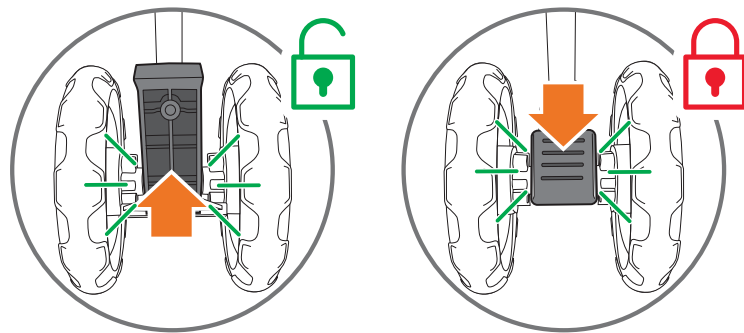

## SECURE CHILD IN SEAT

10-1

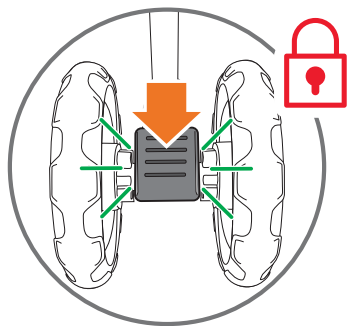

10-2

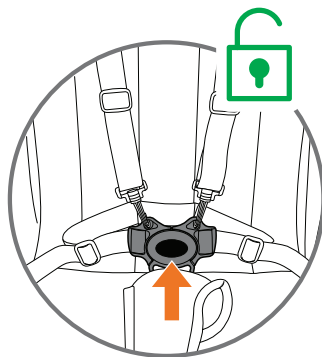

10-3

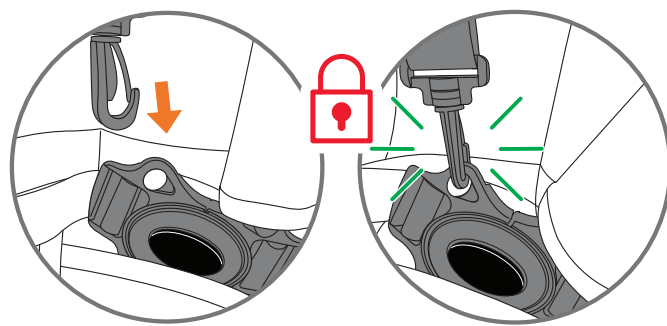

10-4

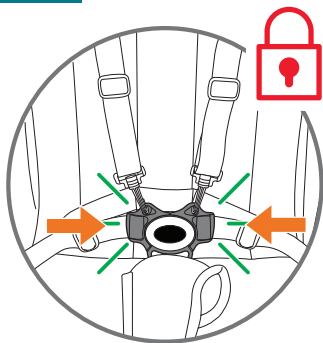

10-5

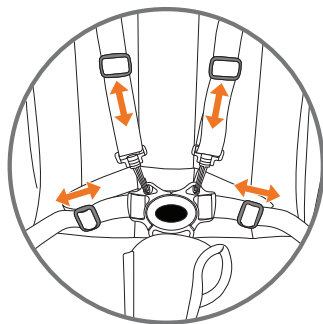

## ADJUST SHOULDER STRAP HEIGHT

11-1

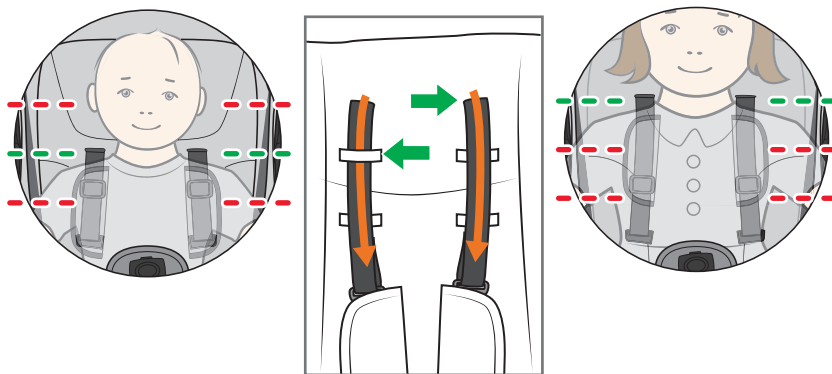

# FOLD STROLLER

12-1

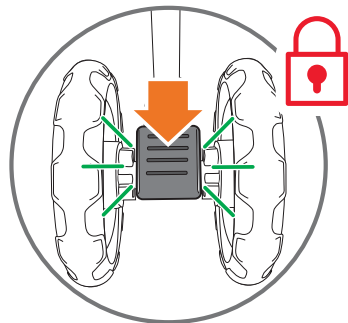

12-2

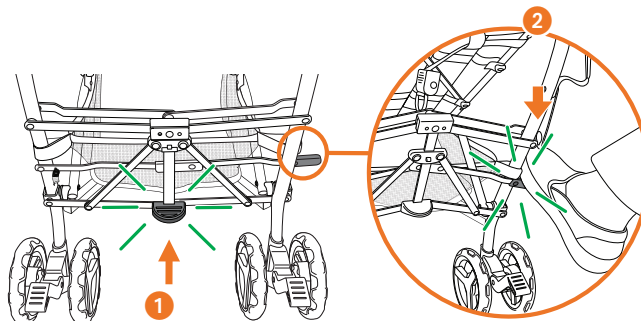

12-3

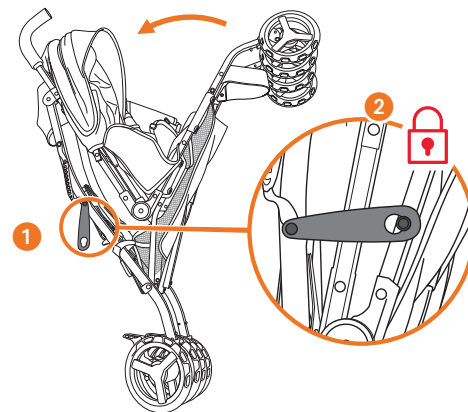

## CARE & MAINTENANCE

- Clean plastic and metal parts with damp cloth and wipe dry.
- Spot clean fabric with mild soap and water solution.
- If stroller becomes wet, wipe with a soft cloth to prevent rusting on metal frame.
- When storing stroller, never stack other items on top of or in it; this may damage the stroller.
- Periodically check for worn parts, loose screws, or torn materials and stitching.
- Replace any damaged parts immediately.

Contours® - United States  
1100 W Monroe St  
Chicago, IL 60607

1-888-226-4469  
customerservice@contoursbaby.com